

**RE260 (3 POLE) DC MOTOR**

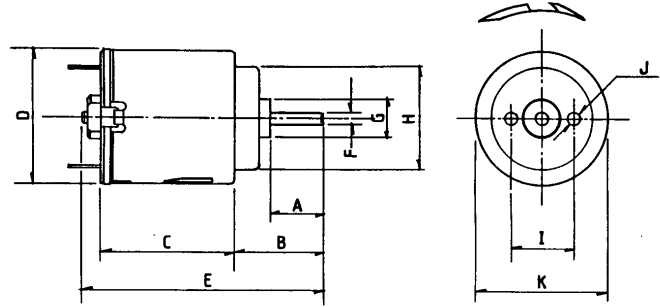

Part No: 457RE260 (MOTOR WITH BRACKET)  
 Part No: 719RE260 (MOTOR WITHOUT BRACKET)  
 Part No: 724 MOTOR BRACKET (90° ONLY)



**Weight: 29g (approx)**

DIMENSIONS	A	B	C	D	E	F	G	H	I	J	K
Millimeter	8.2	11.3	23.5	23.7	42.0	2.0	6.1	19.1	11.5	2.3	23.7
Decimal Inches	0.32	0.44	0.93	0.93	1.65	0.079	0.24	0.75	0.45	0.09	0.93

**MOTOR DATA. (RE260)**

MODEL	VOLTAGE		NO LOAD		AT MAXIMUM EFFICIENCY						STALL TORQUE		
	OPERATING RANGE	NOMINAL	SPEED	CURRENT	SPEED	CURRENT	TORQUE		OUTPUT	EFF	TORQUE		
			R.P.M.	A	R.P.M.	A	oz-in	g-cm	W	%	oz-in	g-cm	
RE260	3 - 6	3v Constant	4242	0.042	3296	0.151			6.8	0.345	33.91		30.61
RE260	3 - 6	4.5v Constant	6722	0.065	5256	0.227			9.9	0.53	50.4		45.9
RE260	3 - 6	6v Constant	8478	0.087	6587	0.302			13.6	0.92	31.5		61.84

Stall Current: RE260 at 3v = 0.58A, At 4.5v = 0.84A, at 6v = 1.10A