

RE360 (3 POLE) & RE360/1 DC MOTOR

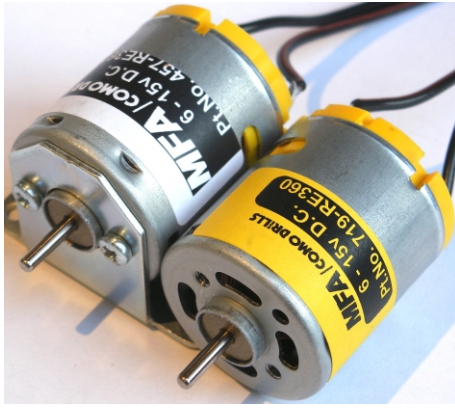

- Part No: 457RE360 (MOTOR WITH BRACKET)
- Part No: 719RE360 (MOTOR WITHOUT BRACKET)
- Part No: 457RE360/1 (MOTOR WITH BRACKET)
- Part No: 719RE360/1 (MOTOR WITHOUT BRACKET)
- Part No: 725 MOTOR BRACKET (90° ONLY)

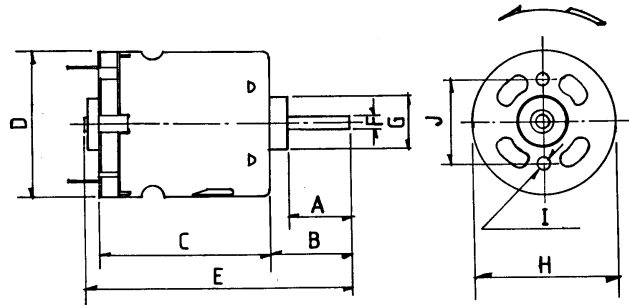

Weight: 51g (approx)

DIMENSIONS	A	B	C	D	E	F	G	H	I	J
Millimeter	8.2	11.5	32.5	27.63	47.0	2.305	10.0	27.5	M2.6	16.0
Decimal Inches	0.323	0.453	1.28	1.088	1.85	0.091	0.394	1.083		0.63

MOTOR DATA. (RE360 & RE360/1)

MODEL	VOLTAGE		NO LOAD		AT MAXIMUM EFFICIENCY						STALL TORQUE	
	OPERATING RANGE	NOMINAL	SPEED	CURRENT	SPEED	CURRENT	TORQUE		OUTPUT	EFF	STALL TORQUE	
			R.P.M.	A	R.P.M.	A	oz-in	g-cm	W	%	oz-in	g-cm
RE360	6 - 15	12v Constant	10420	0.143	8768	0.758		64.2	5.8	63.5		405.0
RE360/1	3 - 6	6v Constant	10450	0.31	8706	1.55		63.4	5.6	60.9		379.8

Stall Current: RE360 at 12v = 4.02A. RE360/1 at 6v = 7.73A