

**RE540/1 (3 POLE) DC MOTOR**



**Weight: 146g (approx)**

Part No: 457RE540/1 (MOTOR WITH BRACKET)  
 Part No: 719RE540/1 (MOTOR WITHOUT BRACKET)  
 Part No: 726 MOTOR BRACKET (90° ONLY)

24 volt versions are available for this range of motors. Performance data is similar to 12 volt versions. This version also has an extended 10mm rear shaft to accommodate motor encoders.

Part No's: 457RE540124V  
 719RE540124V

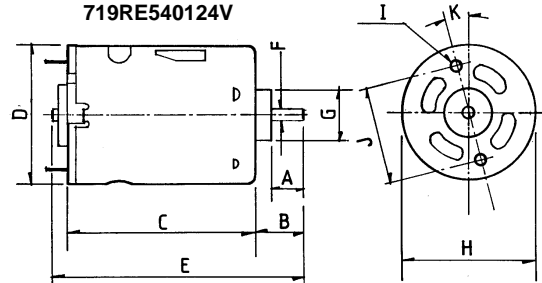

DIMENSIONS	A	B	C	D	E	F	G	H	I	J
Millimeter	9.0	13.5	50.0	35.8	68.0	3.175	13.0	35.7	M3	25.0
Decimal Inches	0.354	0.531	1.969	1.409	2.67	0.125	0.512	1.406		0.984

**MOTOR DATA. (RE540/1)**

MODEL	VOLTAGE		NO LOAD		AT MAXIMUM EFFICIENCY				STALL TORQUE			
	OPERATING RANGE	NOMINAL	SPEED R.P.M.	CURRENT A	SPEED R.P.M.	CURRENT A	TORQUE oz-in	TORQUE g-cm	OUTPUT W	EFF %	oz-in	g-cm
RE540/1	4.5 - 15	6v Constant	7500	0.45	6180	2.1	1.64	118.2	7.49	59.4	9.31	670
RE540/1	4.5 - 15	12v Constant	14500	0.7	12048	2.81	2.22	160	19.8	62.71	14.29	1029

Stall Current: RE540/1 at 6v = 8.24A Stall Current RE540/1 at 1.5v = 2.41AA